



Long Branch Lakes

AT FALL CREEK FALLS | SPENCER, TENNESSEE
[LONGBRANGLAKES.COM](http://longbranchlakes.com)



The Woodlands

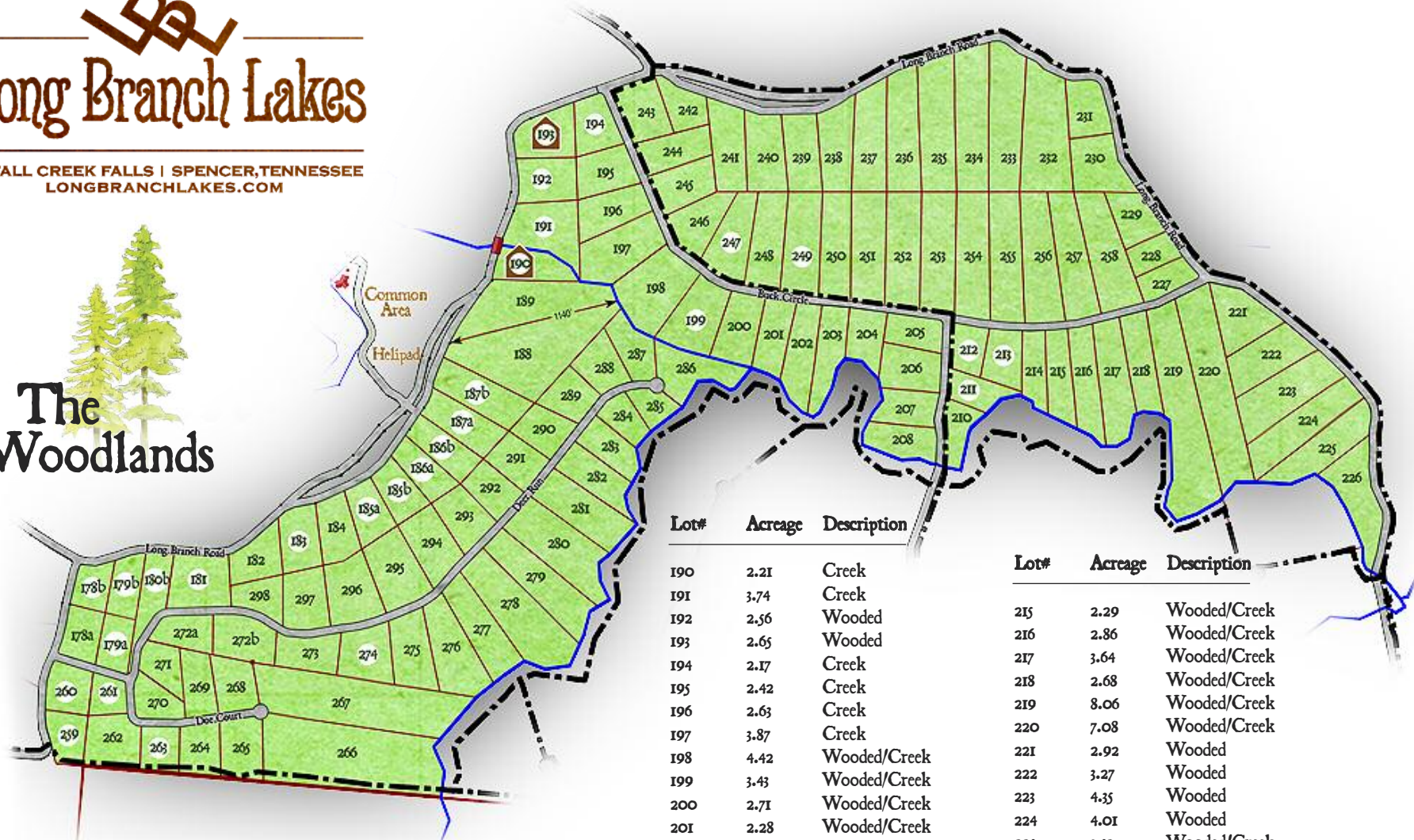

Lot#	Acreege	Description
178a	1.92	Wooded/Pasture
178b	1.59	Wooded/Pasture
179a	1.74	Wooded
179b	1.86	Wooded
180a	1.85	Wooded
180b	2.12	Wooded
181	3.15	Wooded
182	2.25	Wooded
183	2.5	Wooded

Lot#	Acreege	Description
184	2.28	Wooded/Pasture
185a	2.05	Wooded/Pasture
185b	2.01	Wooded/Pasture
186a	2	Wooded/Pasture
186b	2.25	Wooded/Pasture
187a	2.7	Wooded
187b	3.26	Wooded
188	5.67	Creek
189	5.61	Creek

Lot#	Acreege	Description
190	2.21	Creek
191	3.74	Creek
192	2.56	Wooded
193	2.65	Wooded
194	2.17	Creek
195	2.42	Creek
196	2.63	Creek
197	3.87	Creek
198	4.42	Wooded/Creek
199	3.43	Wooded/Creek
200	2.71	Wooded/Creek
201	2.28	Wooded/Creek
202	2.83	Wooded/Creek
203	2.58	Wooded/Creek
204	2.01	Wooded/Creek
205	2.03	Wooded
206	2.3	Wooded/Creek
207	2.07	Wooded/Creek
208	2.29	Wooded/Creek
210	1.68	Wooded/Creek
211	1.7	Wooded/Creek
212	1.69	Wooded
213	2.03	Wooded
214	1.79	Wooded/Creek

Lot#	Acreege	Description
215	2.29	Wooded/Creek
216	2.86	Wooded/Creek
217	3.64	Wooded/Creek
218	2.68	Wooded/Creek
219	8.06	Wooded/Creek
220	7.08	Wooded/Creek
221	2.92	Wooded
222	3.27	Wooded
223	4.35	Wooded
224	4.01	Wooded
225	3.52	Wooded/Creek
226	3.63	Wooded/Creek
227	1.57	Wooded
228	1.44	Wooded
229	2.06	Wooded
230	2.87	Wooded
231	2.21	Wooded
232	5.67	Wooded
233	4.96	Wooded
234	4.87	Wooded
235	4.77	Wooded
236	3.96	Wooded

Lot#	Acreage	Description
237	3.56	Wooded
238	2.93	Wooded
239	2.69	Wooded
240	3.03	Wooded
241	3.04	Wooded
242	1.79	Wooded
243	2.66	Wooded
244	2.42	Wooded
245	2.33	Wooded
246	2.56	Wooded
247	3.10	Wooded
248	3.18	Wooded
249	3.73	Wooded
250	3.22	Wooded
251	3.8	Wooded
252	3.96	Wooded
253	4.14	Wooded
254	4.23	Wooded
255	4.22	Wooded
256	4.42	Wooded
257	3.99	Wooded
258	4.39	Wooded
259	1.81	Wooded
260	2.05	Wooded
261	1.34	Wooded
262	2.78	Wooded
263	1.71	Wooded
264	2.05	Wooded
265	2.52	Wooded
266	11.11	Wooded/Creek
267	9.35	Wooded/Creek
268	2.16	Wooded
269	2.03	Wooded
270	1.53	Wooded
271	1.71	Wooded
272a	2.01	Wooded
272b	2.56	Wooded
273	2.20	Wooded
274	2.69	Wooded
275	2.92	Wooded
276	3.81	Wooded/Creek
277	3.41	Wooded/Creek

Lot#	Acreage	Description
278	5.70	Wooded/Creek
279	4.25	Wooded/Creek
280	4.90	Wooded/Creek
281	3.96	Wooded/Creek
282	2.57	Wooded/Creek
283	2.05	Wooded/Creek
284	1.51	Wooded/Creek
285	1.22	Wooded/Creek
286	2.98	Wooded/Creek
287	2.51	Wooded/Creek
288a	1.91	Wooded
288b	2.78	Wooded
289	1.66	Wooded
290	1.70	Wooded
291	2	Wooded
292	1.94	Wooded
293	2.30	Wooded
294	2.82	Wooded
295	3.41	Wooded
296	3.16	Wooded
297	2.57	Wooded
298	1.70	Wooded
299	2.12	Wooded



Long Branch Lakes

AT FALL CREEK FALLS | SPENCER, TENNESSEE
[LONGBRANCHLAKES.COM](http://longbranchlakes.com)

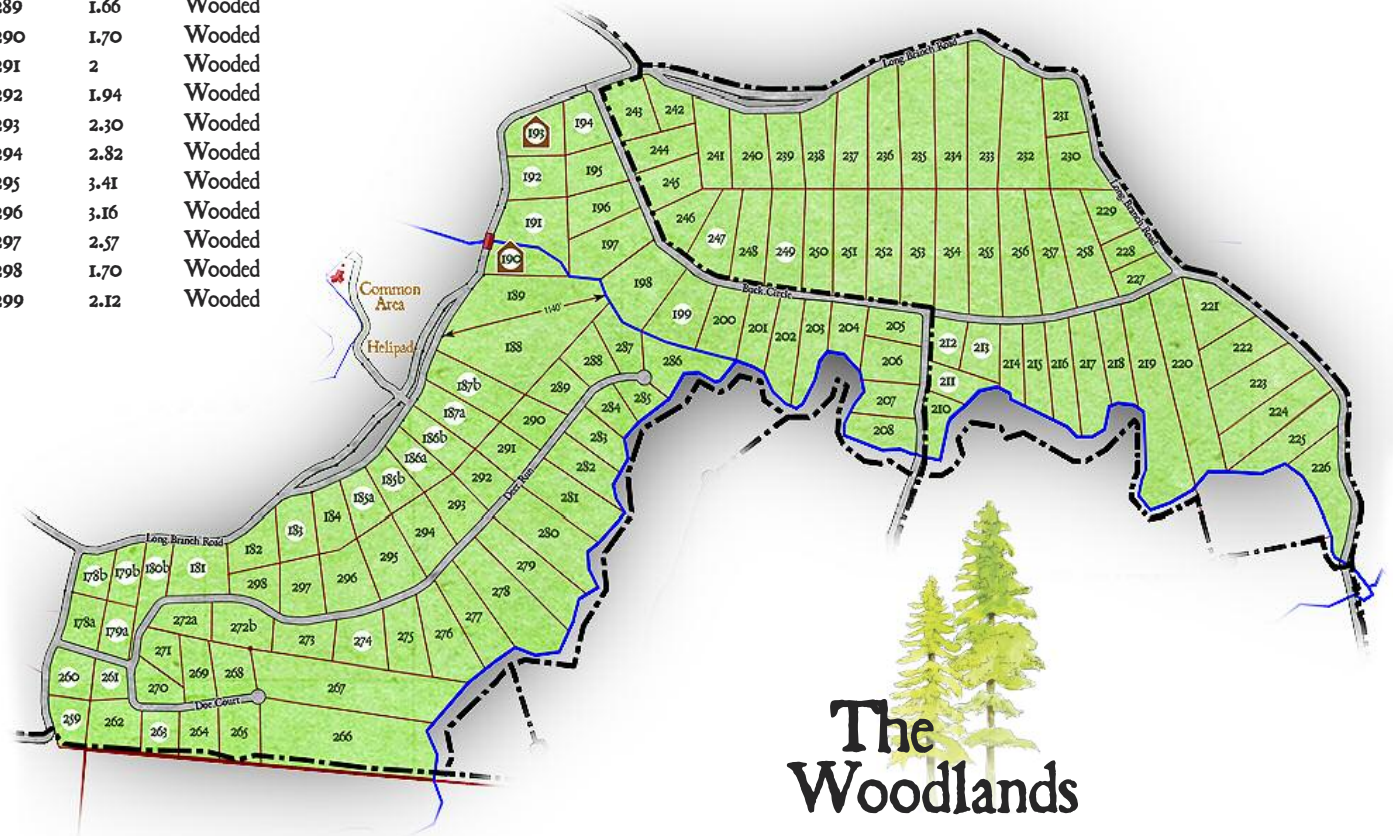

The
Woodlands



These materials, features and amenities described and depicted herein are based upon current development plans, which are subject to change without notice. No guarantee is made that the features, amenities and facilities depicted by artists' renderings or otherwise described herein will be provided, or if provided, will be of the same type, size or nature as depicted or described. Obtain the Property Report required by Federal Law and read it before signing anything. No Federal Agency has judged the merits or value, if any, of this property. Jeremy C. McDowell, Principal Broker for Long Branch Lakes Properties, LLC.