

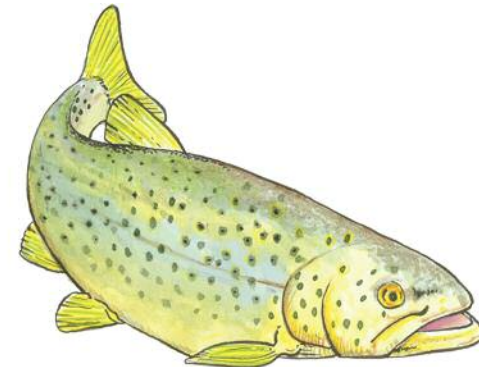

Long Branch Lakes

AT FALL CREEK FALLS | SPENCER, TENNESSEE
 LONGBRANCHLAKES.COM



Trout Creek

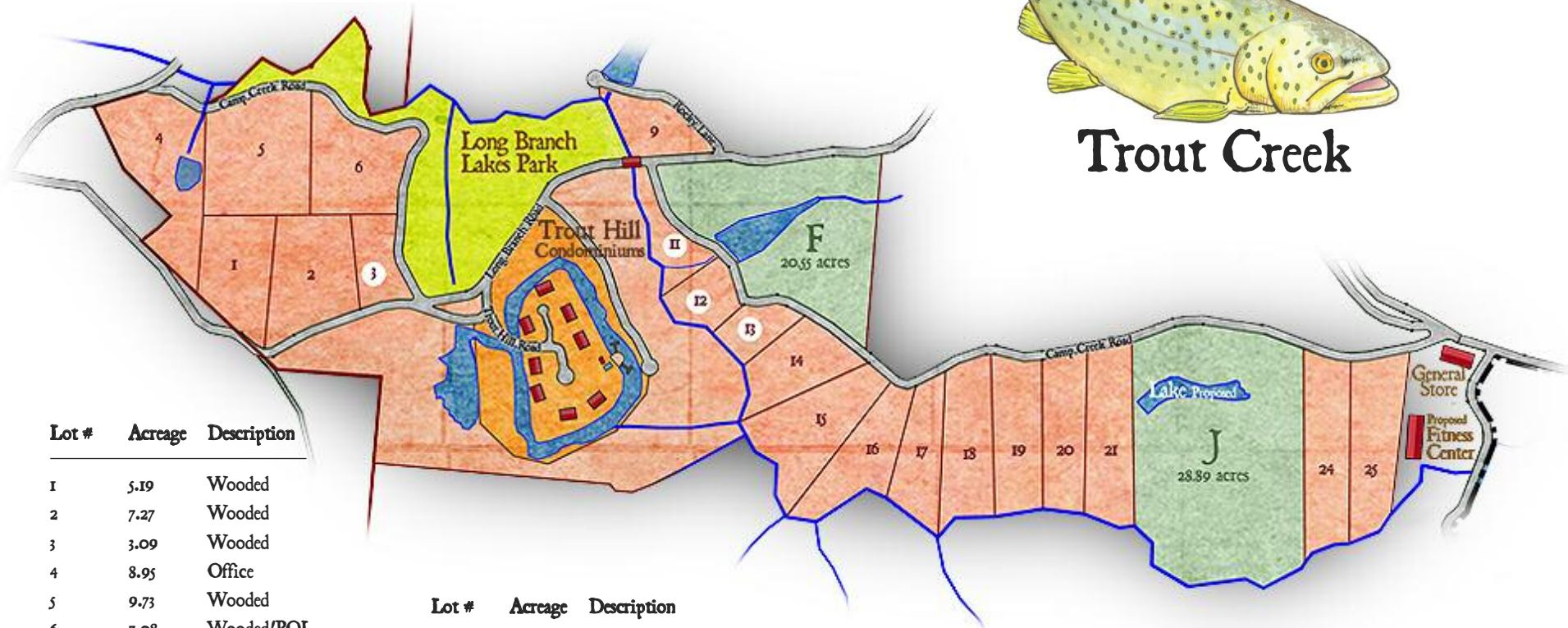

| Lot # | Acreage | Description |
|-------|---------|-------------------|
| 1 | 5.19 | Wooded |
| 2 | 7.27 | Wooded |
| 3 | 3.09 | Wooded |
| 4 | 8.95 | Office |
| 5 | 9.73 | Wooded |
| 6 | 7.08 | Wooded/POL |
| 7 | 9.89 | Creek/Wooded/Park |
| 8 | 7.99 | Park |
| 9 | 3.51 | Creek |
| F | 20.55 | Creek |
| II | 2.9 | Creek |
| 12 | 2.84 | Creek |
| 13 | 2.25 | Creek |

| Lot # | Acreage | Description |
|-------|---------|-------------|
| 14 | 5.05 | Creek |
| 15 | 7.52 | Creek |
| 16 | 5.52 | Creek |
| 17 | 4.6 | Creek |
| 18 | 6.26 | Creek |
| 19 | 5.96 | Creek |
| 20 | 5.22 | Creek |

| Lot # | Acreage | Description |
|-------|---------|-------------|
| 21 | 6.48 | Creek |
| J | 28.89 | Creek |
| 24 | 6.88 | Creek |
| 25 | 6.7 | Creek |
| 26 | 7.67 | Common Area |



These materials, features and amenities described and depicted herein are based upon current development plans, which are subject to change without notice. No guarantee is made that the features, amenities and facilities depicted by artists' renderings or otherwise described herein will be provided, or if provided, will be of the same type, size or nature as depicted or described. Obtain the Property Report required by Federal Law and read it before signing anything. No Federal Agency has judged the merits or value, if any, of this property. Jeremy C. McDowell, Principal Broker for Long Branch Lakes Properties, LLC.